

State House First Floor

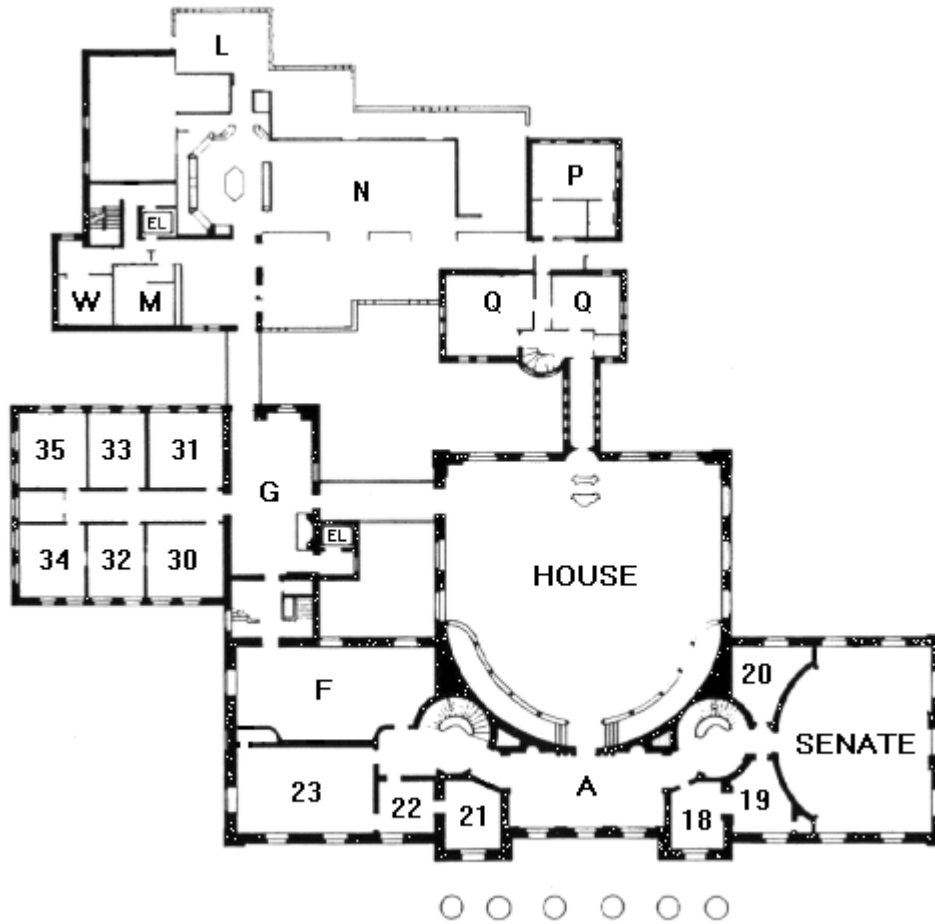

State House Second Floor



STATE HOUSE DIRECTIONS AND ETIQUETTE

Where to go:

- Room 10: Afternoon Seasoned Advocate Advocacy Seminar meeting location.
- Room 11: Afternoon New Advocate Advocacy Seminar meeting location.
- Cafeteria (N): Labeled N on the map. Activities for kids, legislator letter writing station, and meeting location for those who attended the rally (but not ECDL) who want to take a tour of the State House.
- The cafeteria is also open until 3 PM if you would like to purchase a snack or beverage.
- Card Room (G): Learn more about the issues on the Alliance's 2020 Legislative Agenda by visiting the displays in the card room.
- Restrooms (M or W): Restrooms are located the first and second floors.
- Elevator (EL): The elevator is located outside the Legislators' Lounge on the first floor and near the Card Room on the second floor.

When you're in the State House:

- No rally signs or pom poms in the building.
 - You can leave signs with a volunteer to be recycled as you enter the building, or you can leave them in your car if you would like to keep them.
 - Please stow pom poms away in your coat pockets or bag before you enter the building or leave them in your care.
- Remember that the State House is the People's House, but it's also a place where 180 legislators and a host of staff go to work every day. Please use quiet voices and be respectful. Imagine that you're in the middle of someone's office.
- Address legislators by their proper titles (Representative X and Senator Y) unless they've previously asked you to call them by their first names.
- Legislators are very busy people. Unless you've made a prior appointment with them, they may not be able to find time to meet with you today. It doesn't hurt to ask (nicely), but be gracious if the answer is no. Ask what time would work better and set up a time in the future!
- Remember that we as advocates need all members of the Legislature to be champions for children in the future, so we want to strike a positive tone. If you're speaking to legislators about a bill or an issue, use a positive and appreciative approach. It never hurts to say thank you!
- Food is allowed in the cafeteria and Room 10. Please do not have food or drinks in any other rooms.
- Remember to turn off your cell phone if you are going into a committee room or the Senate or House chamber.